

Serving: Carvel, Darwell, Duffield, Wabamun, Seba Beach, Gainford, Entwistle, Evansburg, Wildwood, Tomahawk, Spruce Grove, Stony Plain & Drayton Valley

July 19, 2016

YELLOWHEAD COUNTY GARDEN PRIDE SHOWCASE TOUR



Submitted by Stefan Felsing

“The very popular County Pride Tour provides a look at some outstanding examples of the beautiful landscaping that



can be done with the plants that flourish in this climate,” says Yellowhead County Agricultural Services Supervisor Jennifer Benson.

“Although our local climate presents some big challenges



for gardeners, it is inspiring to see the clever and creative ways that gardens have been adapted to flourish here.”

Continued on Page 2

NEW GROUCH CANDIDATES SHARPENING THEIR SKILLS!

Submitted by Al Hagman

July has arrived and so has the new slate of candidates vying for the esteemed title of “Evansburg Grouch.” Jennifer Yakimchuk has done a wonderful job for the past year spreading her venom across both sides of the river. Her last appearance was just at the Entwistle Rodeo where she received a big kiss from some clown—actually the rodeo’s clown, Earl! Alas, all good things must end, and her grouchiness is at the all-time low ebb. Fortunately, the newbies are a class of a couple of top performers and it looks like we are set for a dilly of a race.



Take a look at our first candidate, Don (The Incredible Sulk) Gibbs. Don resides in the Evansburg Lodge with his wife Sharon. Don has 6 children and is well known by residents there. Don has had a storied past serv-

ing as a mechanic in the military and was stationed in Germany, New Brunswick, and Ontario. He spent time working for Flint in High Level and lived in Sanguo before Evansburg. Do not be fooled by his calm, relaxed appearance—Don is no rookie in the “grouching” department. He is cat-like in his ability to pounce on unsuspecting prey, before they have had a chance to defend themselves. His motivation comes from living in the communal environment that is the Evansburg Lodge. He is especially irritable in the morning until he has had his breakfast.

Continued on Page 3

L&B Water Services Ltd. Tradition of Quality & Service

Well & Pump Repairs
Complete Pressure Systems
Farm - Residential - Commercial
Potable Water Cisterns

BILL RIEDLINGER ERNIE BLEKER
PH. 780-963-8134 OR 780-963-7749
LBWATER@XPLORNET.COM

Casual Connexion

STORE WIDE CLEARANCE
30%-40% OFF
Regular Priced Items
Ezze Wear & Red Hats

1-5009 50 St. Stony Plain, AB
PH: (780) 968-2763

Bayberries Intimates

- Bras A - L Cup, 30 - 56 Bands, XS to 3XL
- Sleepwear • Lingerie

Mainstreet, Stony Plain
780-963-1199
Like us on Facebook

KEVIN DAVIS
CONCRETE CONSTRUCTION
Commercial - Residential | 25 Years Experience

- Sidewalks
- Garage Pads
- Shop Floors
- Driveways
- Exposed Aggregate
- Basements
- Patios
- Steps
- Curbs
- Stamps

Phone: (780) 924-2031
Cell (780) 868-2228



PUBLISHED WEEKLY (Zone 1 & 2)
AND BIWEEKLY (Zone 3)

E.J. Lewchuck & Associates Ltd.

45C South Avenue
Box 3595
Spruce Grove, AB T7X 3A8

SALES

Elaine Lewchuck
Ashley Cazac

TELEPHONE:

Classifieds 962-9229
Advertising 962-9228
Fax 962-1021

E-MAIL:

sales@com-voice.com
news@com-voice.com

Yellowhead County Garden Pride Showcase Tour

Continued From Page 1

The contest and tour is in its thirteenth year! The tour will take place on Thursday, July 28, 2016. The bus will load in Edson, Niton, and at the Wildwood Complex.

In the judging process, properties were graded for over-all presentation, including neatness

and use of space. This is followed by a closer look at the following categories:

- Lawn care
- Flowerbeds/ gardens- including vegetable
- Species variety & health
- Buildings
- Management practices

In addition to viewing the many beautiful spots, tour participants

will have plenty of opportunity to socialize with others on the tour, whether they are gardeners or not, and talk to the winning gardeners and learn more about plants and plant care.

The tour will include nutritional breaks and the lunch cost is \$35/person. Registration deadline for this tour is July 25, 2016. Please register early as space is limited. To register or get more details call Yellowhead County office in Wildwood at 325-3782 or 1- 800 814-3935.

JOKE OF THE WEEK

Q: What do you call a computer floating in the ocean? **A:** A Dell Rolling in the Deep.

Q: What did Bacon say to Tomato? **A:** Lettuce get together!

Q: Did you hear about the shampoo shortage in Jamaica? **A:** It's dread-ful.

Q: What is it called when a cat wins a dog show? **A:** A CAT-HAS-TROPHY!

Like Us On facebook

FACEBOOK.COM/
COMMUNITY VOICE
NEWSPAPER

Rebecca Pawlechko,
BSc, MSW, RSW
Counseling Services

Special Interests: EMDR, Hypnosis, Past-Life Regression Hypnosis

Unique Perceptions
319 McLeod Avenue
Spruce Grove, AB T7X 0J6
780 405 1597

rebeccapawlechko@gmail.com
www.rebeccapawlechko.vpweb.ca

Sunday to Thursday 8:00 - 8:00PM
Friday & Saturday 8:00 - 10:00PM
Fully Licensed Happy Hour
4:00 - 7:00PM Every Day!

“Where Friends Meet”

CAESAR

SUNDAY'S

Caesar Salad & Caesar Cocktail

\$8.00

Pizza to Go - Original Pizza

Check our Website for Upcoming Events
KokaneeGrill.com

Call (780) 797-3100
Hwy 31, Seba Beach, AB | Lake Wabamun

LAWYER

PATRICK DOLPHIN

Evansburg
Office open Mondays
9:30a.m. to 4:00p.m. (except holidays)

Office located near Drug Store

Phone: 780-727-2270

Serving Evansburg, Entwistle and area since 1994

New Grouch Candidates Sharpening Their Skills!

Continued From Page 1



Don, but he said 43 years with his wife is "just like it!" He did work as a trucker, a heavy equipment operator, and more recently as a stucco contractor. His pet peeve is the people who think they know everything—because he believes he is the only one who knows everything! His motto in life is "Liver to the Fullest!" or was it "Live'er to the Fullest!"

So you can see that, if either Don or Randy is elected we will be in good hands. Coffee cans have been placed throughout the businesses in Evansburg and Entwistle with pictures of these grumblers on the front. Put your cash in the slot above the picture of the grouser that you wish to see carry the torch for 2016. That

Our second candidate is Randy (The Rottweiler) Trydal. Randy resides in Evansburg and lives along with his wife Cathy. He met Cathy while she worked in the Voyageur restaurant in Edson. Randy and Cathy have 3 children, 4 grandchildren, and have lived in both Entwistle and Evansburg. If living in Entwistle wouldn't put you in a bad enough mood, moving to Evansburg across from the ball diamonds was enough to make him look like he does in this picture. He didn't work in the military like

money will go into the PV Daze coffers to help pay the considerable costs associated with putting on PV Daze. The moaner with the largest

total on Friday, August 5th will be crowned at the pancake breakfast on Saturday, August 6th. The crowning ceremony will begin @ 9:00 a.m.

Tipple Park Museum is Hiring!

Museum and Market Manager

Please see full job description at www.tippleparkmuseum.com
Closing date July 29th, 2016

Please email resume and cover letter to bilawton@telus.net
 Attention Irene Lawton, President
 Phone 780-727-2393
**** Position is located in Evansburg, Alberta ****

Only candidates selected for an interview will be contacted

Yellowhead County

RECEPTIONIST/ADMINISTRATIVE ASSISTANT
LOCATION: WILDWOOD OFFICE
COMPETITION NO. 16-18-C

Reporting to the Accounting Supervisor, the Receptionist/Administrative Assistant-WW position is responsible to provide reception and administrative support services in the Wildwood Office.

The salary for this position is \$42,457 - \$53,739. Yellowhead County offers a competitive benefit package.

For a more detailed list of qualifications and complete Position Description go to the County web site at www.yellowheadcounty.ab.ca or contact our office.

Submit resumes in confidence no later than **4:30 P.M., Wednesday July 27, 2016**, quoting Competition No. **16-18-C** to:

Patricia Pape, Payroll/HR Coordinator
 Yellowhead County

- Mail: 2716 - 1st Avenue, Edson, Alberta T7E 1 N9
- Fax: 1-780-723-5066
- Email: ppape@yellowheadcounty.ab.ca

No phone calls please.

The personal information obtained as a result of this advertisement will be utilized for this employment opportunity only, and is subject to compliance with the Freedom of Information and Protection of Privacy Act.

We thank all applicants for their interest; however; only those selected for an interview will be contacted.

DARWELL PUBLIC LIBRARY NEWS

Submitted by Sandra Stepaniuk, Library Manager

We are hiring!

We currently have an open Library Assistant position at the library. Do you love the library and books? Do you foster a genuine commitment to your community and support true intellectual freedom? We are looking for that special person who is flexible and can always provide excellent customer service, deal effectively with diverse people of all ages and is comfortable

with technology; this could be the opportunity for you. You will work 8.5 hours per week with the potential for more hours covering sick days, holidays and programs. A current vulnerable sector check will be required. Please submit your resume, for consideration, to Library Manager Sandra Stepaniuk no later than Friday, August 5, 2016.

The Summer Reading Club, for children 6 to 13 years of age, starts Thursday, July 14 from 1 – 3PM and will run for six consecutive Thursdays until August 18,

2016. The theme this year is “Go Wild” and each week we will explore fun and creative ways to “Go Wild”. This is a free program that will include stories, activities or games, crafts and a snack. We still have a few spots available, register soon to avoid disappointment. The maximum space available for the program is 15.

As promised, we are opening the green book shed and have scheduled a few more used book sales. The dates and times are as follows: Wednesday, July 20

from 5-8 pm, and Monday July 25 from 1-4 pm. We encourage you to drop by and peruse the titles, take what you want and leave a donation of your choosing. All money received will go directly towards the completion of the library expansion. See you there!

We will be holding a silent auction during the Darwell Fair in the new library expansion. We are currently accepting donated new items for our event so should you have something you would like to contribute, please contact the library. Lisa Losole from Discovery Toys will be assisting us with fundraising to provide materials for use within the library for programs during the Ag-Drum and the Darwell Fair. Check our community board, local papers, and website or like us on Facebook for dates and times.

The Darwell Library Friends Society will be holding a regular meeting on Thursday, July 28, 2016 starting at 7 pm. If you are interested in the library and are looking for ways to contribute this would be the perfect opportunity to get involved.

The Darwell Public Library Society will be holding their next regular meeting on Monday, September 26, 2016 starting at 7 pm. All meetings are open to the public and everyone is welcome to attend. The Library is open 11:00 am to 4:00 pm on Monday, Tuesday and Thursday and from 5:00 pm to 8:00 pm Wednesday and Friday, closed Saturdays, Sundays and Holidays. You can also find out what is happening at the library by checking our Website www.darwellpubliclibrary.ab.ca or like us on Facebook at www.facebook.com/DarwellPublicLibrary

House for Sale to be Moved



#1. 1978 log house, approx. 1,826 ft².

1 bedroom, 1 bathroom, log home with vaulted ceilings. The entry area, kitchen and bathroom all have tile flooring, dining room and living room have hardwood flooring. The dining room and living room share a custom stone faced fireplace which extends to the ceiling.

#2. Chain Link Fence

Approx. 360 metres of chain link fence, 6 ft tall. Still installed, buyer must dismantle.

#3. Metal Shed: Approx. 16' X 8' steel shed

All buildings will be sold by sealed bid. Sealed bids will be accepted until 4pm on **Wednesday, August 24, 2016**. No fax or email bids will be accepted.

Mail bids to:

Capital Power
"Building Sale"
Box 20, Site 2, RR1
Warburg, Alberta, T0C 2T0

Location:

West side of RR31, south of Twp 502
Legal address: SE 11-50-3 W5
Municipal address: 50128 RR31

Buildings can be viewed:

- Wednesday, August 3, 2016 from 3pm- 8pm
- Saturday, August 6, 2016 from 10am – 3pm

Open House: Wednesday, August 3, 2016 from 3pm- 8pm & Saturday, August 6, 2016 at 10am to 3pm.

Contacts:

Jennifer Tkachuk, 780-969-8706 (jtkachuk@capitalpower.com) or George Greenhough, 780-969-8618 (ggreenhough@capitalpower.com) for more information or to receive an illustrated bid package.

HOUSE MUST BE MOVED BY MARCH 1, 2017



THE EVANSBURG FARMERS' MARKET IS A GREAT PLACE TO BE!

Submitted by Rena Traxel, Museum and Farmers' Market Manager

The Evansburg Farmers' Market is in full swing. The market is averaging between 150-250 shoppers per week with weekly regulars dropping in for coffee and a chat. If you have already been to the market, thank you for your support. If you still need some convincing here is a glimpse into a day at the Evansburg Farmers' Market.

At 8 am the manager arrives to let the vendors in. For the next two hours, Tipple Park Museum is transformed into a marketplace with the majority of vendors inside the reception building. At least 80% of products are handmade, homegrown or baked by local farmers and artisans.

The smell of juicy hamburgers and hot dogs wafts from the kitchen concession. By the kitchen, there is a table for enjoying coffee and a bite to eat. Or if patrons prefer they can wander out to the park and snatch up a picnic table to enjoy the summer sun. Out on the back pad Museum staff set up a table for that week's craft such as puppet making, rain sticks or necklaces. There are also games such as jacks, hopscotch and bocce. Many kids take part in this free drop-in program.

After shopping and eating, patrons are welcome to a tour of the Holly Springs School, the Mazeppa Log House and the A-Frame. After the market, the temporary exhibit space, currently hosting the Communication exhibit, is opened.

Too soon the market is over, and vendors are packing up for the day. Luckily regular offerings such as Specialty Meats, baking, Ukrainian food, leather work, wood work, art, Watkins, handmade cards and stamped candles and knitting return every Saturday and vegetables are now in season! Other vendors attending some Saturdays include offerings such as stained glass, handmade jewellery, handcrafted barrettes and more, leggings, doll clothes, blankets, aromatherapy magic

bags, signs, clothes and much, much more. There will be other vendors later in the season providing Taber corn, homemade soap and variety of vegetables.

Of course, new vendors and patrons are welcome!

Please pop in, grab a newspaper, chat with staff and vendors and see what this great market

has to offer. The market runs every Saturday from 10-2 until the end of September with two special markets November 19th and December 3rd.



Rochfort Colony Veggie Stand

780.893.1244 Monday - Saturday **780.785.3208**
9:30 a.m. - 7:00 p.m.

Sunday
Noon - 7:00 p.m.



Bread & Buns



Pies & Baking





Fresh Honey



**Fresh Vegetables
(in season)**



Pickles & Jam



Farm Fresh Eggs



Pepperoni



Frozen Chicken



Jerky



Fresh & Frozen Meat



Potatoes



Chicken Steaks



Order FRESH Chicken and Turkey anytime

Local made Handicrafts



DARWELL AND DISTRICT AGRICULTURAL SOCIETY

Darwell AG Drag

Barn Burner Music Fest

11TH ANNUAL BARN BURNER MUSIC FESTIVAL

Friday, August 12th, 2016

Doors open at 6pm Show at 7pm

Featuring:
Jess Moskaluke with
special Guests: Tebey,
Drew Gregory and
Amber Haydey

ALL AGES
OUTDOOR CONCERT
BEER GARDENS

Tickets \$40 in advance and
\$50 at the door. Tickets available
on darwellag.com and at
TicketWeb and local retailers



21ST ANNUAL DARWELL AG DRAG TRUCK & TRACTOR PULL

Saturday, August 13th, 2016
DOORS AT 4:00PM SHOW AT 6:00 PM

Sunday, August 14th, 2016
DOORS AT 11:30AM SHOW AT 1:00 PM

ADMISSION \$15 | 5 AND UNDER FREE



MONSTER RIDE TRUCK

RETURNING IN 2016. MONSTER TRUCK FREESTYLE DEMO

BY "SHEER INSANITY"
BOTH DAYS AS WELL AS
MONSTER TRUCK RIDES!
(SEE DARWELLAG.COM
FOR PICTURES)

"VILLAGE GLASS FIREWORKS SHOW"

SATURDAY, AUGUST 13TH, 2016 @ APPROX 10:30 PM
ENTER TO WIN "RETURN AIRFARE FOR TWO" COURTESY OF
WESTJET (RULES AND RESTRICTIONS APPLY)

Competition Chevrolet presents the 21st Annual Darwell Ag Drag

Brought to you by:

Jack's Auto Body, RPTL Dilfield &
Equipment Hauling, Tractor Ranch,
Cat Rental Store, Morand Industries,
TransAlta, H & P Kosik Construction,
NADP, Byrile Auto, Patricia Halder -
Realty Executives, Tim Hoy Trucking
and Construction, Equis, Village Glass
and Mirror, Mysback Sales and
Rentals, Stoney Creek Services,
Jungles Bar and Grill, Woodhaven
Cabinets, Community Voice, Graham
Construction, Fullis Country Store



FOR MORE INFORMATION VISIT DARWELLAG.COM

DARWELL AND DISTRICT AGRICULTURAL SOCIETY
72ND ANNUAL SUMMER FAIR

AUGUST 20 & 21, 2016
SATURDAY: ADULTS \$5.00 SENIORS & CHILDREN 6 TO 12 YEARS \$3.00 SUNDAY: FREE ADMISSION

SATURDAY

Morand's Free Pancake Breakfast
 8:00AM - 10:00AM
Prepared by Darwell Volunteer Fire Department

Concession at the Mac Shack 11:30 AM - 5:00 PM

Bench Show in the hall. Entries from 8:00AM - 10:15AM. Judging starts at 10:30AM. Opening for viewing at 1:00PM

Women's Institute Tea 1:00 PM - 3:30 PM

Parade Judging starts at 10:00 AM

Parade starts at 10:45 AM

Market 10:00 AM - 4:00 PM
 at the Tri-Lakes Golden Age Club

L.Kosik Construction's Money Mine ALL WEEKEND
Choo Choo the clown (balloon artist)
 10:00 AM-3:00 PM

Pudytatts Body Art 11:00 AM-4:00 PM
 (face painting & tattoos by Jessica Puhov)

Bob Derouin's Inflatable slide & Bouncy House
 11:00 AM-4:00 PM

Crafts at the Gazebo 11:00 AM-3:00 PM

Funny Farm Large Petting Zoo 11:00AM-3:00 PM

Portable Rock Climbing Wall 11:00 AM-4:00 PM

Dunk Tank 11:00 AM-4:00 PM

Central Alberta Draft Horse Pull
 STARTS AT 11:00AM

Junior Pet, Sheep/Goat & Poultry Show
 STARTS AT 12:00 NOON

Quad Wars STARTS AT 12:00 NOON

Farmers Olymp-hicks
 Outdoor riding arena 1:00 PM

SUNDAY

Concession 7:00 AM - 5:00 PM

Toonie Pancake Breakfast 7:00 AM - 11:00 AM

Horse Show JUDGING STARTS AT 9:00 AM

Market 10:00 AM - 3:00 PM
 at the Tri-Lakes Golden Age Club

Bob Derouin's Inflatable slide & Bouncy House
 10:00 AM-4:00 PM

Cattle Show STARTS AT 11:00 AM

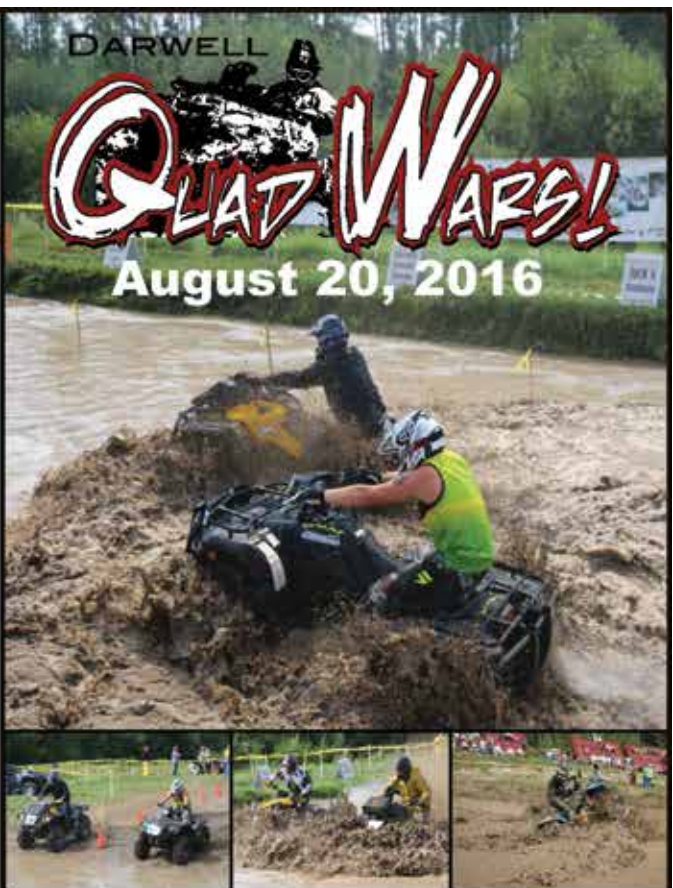

ATV & SSV Mud bog races
Registration 9:00-10:30am
Event Starts at Noon



www.quadwars.com

Sponsored by



Darwell and District Ag Society

FOR MORE INFORMATION VISIT DARWELLAG.COM



**Have you considered Implants
as an alternative to bridges and dentures?**



**DR. KRIS KALHS
GENERAL DENTIST**

- **Cosmetics and Oral Rehabilitation**
- **IV Sedation**
- **Oral Surgery Including Implant Placement and Restoration**

DEDICATED COMMITMENT TO CARE

**CALL FOR AN
APPOINTMENT TODAY!**

KARO

DENTAL CARE

780-962-6670   

www.karodental.ca

**202-8 MCLEOD AVE,
SPRUCE GROVE, AB**

ALMOST JOHNNY CASH!

Submitted by Al Hagman

David James and Big River are often described as one of the most authentic Johnny Cash tribute shows touring today. Thousands of fans agree with those reviews, as they routinely sell out shows across Canada and the States.

James and his band—Todd Sacerty on bass, Duncan Symonds on guitar and pedal steel, and Colin Stevenson on drums—look and sound like the legacy of the Man in Black, and when they step on stage, they live it.

If he had to say just when he started, James would say it was probably back when Joaquin Phoenix was singing Johnny Cash's songs in Walk the Line. "I fell in love with what he did," James recalls. "It inspired me how this guy could live this way and come around and get it all back and make great music throughout."

James is an Alberta native but

his deep voice takes on a southern twang from time to time, like when he says "fella" or guitar ("gee-tar"). Still, he might not have paid the moment much mind if his girlfriend hadn't taken notice. "She was absolutely blown away when I started to sing along. She's like, 'You sound better than Joaquin!'" he recalls. About one year later James looked out at a crowd and said, "Hello, I'm almost Johnny Cash."

David James and Big River are scheduled to play on Friday, August 5th at the Legion Hall in Evansburg as a part of their Pembina Valley Daze Festival. Tickets are \$25 and available at Claire's V & S Dept. store in Evansburg (780-727-3868). Tickets sold out two weeks prior to the show the last time this group performed here. We hope you will come out and support this show this year. "We will sell you a whole seat---but you will only need the edge!"



Family run, local business, we care!

**BEST CISTERN
SEPTIC SOLUTIONS**

**Cistern and Septic Inspection,
Cleaning and Repair!**

**Septic planning, design, installation
by government certified installer(s)**

New Installs Available. Reasonable Rates.

Let Us Handle the Dirty Work

780-668-4306 

best-cistern-septic-solutions.com



RCMP BEATS

Submitted by Stony Plain/
Spruce Grove RCMP

Occurrences for the week of 4
July to 10 July, 2016.

Total Calls for Service Spruce
Grove/Stony Plain/Enoch De-
tachment: 566

Total Calls for Service for the
Victim Service Unit: 32

Persons Crimes: 72

Property Crimes: 96

Impaired Driving Complaints
reported: 10

Impaired Driving Charges
Laid: 1

Roadside Suspensions: 1

Motor Vehicle Collisions At-
tended: 32

Property Crimes:

Spruce Grove

1. July 4 – Area of Balmoral
Drive – Theft from Vehicle, cash
stolen

2. July 5 – Area of Linden
Street – Theft from Vehicle, wal-
let stolen

3. July 5 – Area of Oatway
Street – Theft of Vehicle, 1999
brown Ford F250

4. July 5 – Area of McLeod
Avenue – Theft from Vehicle,
wallet and iPad stolen

5. July 7 – Area of King Street
and Halden Crescent – Theft of
Vehicle, 2001 blue Ford F250

6. July 7 – Area of Calahoo
Road and Marlboro Drive –
Theft from Vehicles, cash, GPS,
paperwork stolen

7. July 10 – Area of Heather-
lands Way – Theft from Vehicle,
garage door opener stolen

8. July 10 – Area of Village
Road and Hwy 16A – Theft of
Vehicle, 1998 grey Dodge Ram
Stony Plain

9. July 9 – Area of 52 Avenue
and 49 Street – Theft of ATV, or-
ange Tao-tao 50cc

10. July 9 – Area of Westerra
Crescent – Theft from Vehicle,
laptop stolen

11. July 9 – Area of Folkstone
Place – Theft of Lawn Orna-
ments

Continued on Page 10

PUBLIC NOTICE

TRANSALTA CORPORATION – KEEPHILLS THERMAL ELECTRIC POWER PLANT

ENVIRONMENTAL PROTECTION AND ENHANCEMENT ACT

NOTICE OF APPLICATION

In accordance with the *Environmental Protection and Enhancement Act*, TransAlta Corporation has applied to Alberta Environment and Parks for a renewal of the existing approval for the continued operation of the Keephills Thermal Electric Power Plant with a total gross generating capacity of 1,354 MW. The plant is located in the northeast quarter of Section 36, Township 51, Range 4 West of the 5th Meridian, approximately 50 km west of Edmonton.

A directly affected person may provide input into certain regulatory decisions, as allowed by the *Environmental Protection and Enhancement Act* (section 73). Specifically, any person who is directly affected by this application may submit a written statement of concern within 30 days of the date of this notice to:

Alberta Environment and Parks
Regulatory Approvals Centre
Main Floor, Great West Life Building
9920 – 108 Street
Edmonton, Alberta T5K 2M4
Fax: (780) 422-0154
Email: esrd.epeapplications@gov.ab.ca

The written statement of concern should include the following:

- the application number (024-10324)
- describe concerns that are relevant to matters regulated by the *Environmental Protection and Enhancement Act*
- explain how the filer of the concern will be directly affected by the activities proposed in the application
- the municipal address and/or legal land location of the land owned or used where the concerns described are believed to be applicable
- state the distance between the land owned or used and the site in the application
- contact information including the full name and mailing address of the filer. Please provide a telephone number and/or email address for ease of contact.

Environment and Parks will review each written statement of concern, seek more information if needed, and notify each filer by letter of the decision to accept or reject their written submission as a valid statement of concern.

Statements of concern submitted regarding this application are public records which are accessible by the public and the applicant. Failure to file a statement of concern may affect the right to file a Notice of Appeal with the Environmental Appeals Board.

Copies of the application and additional information can be obtained from:

TransAlta Corporation
Attention: Greg Milne, M.Sc., P.Eng.
Manager, Environment, Health & Safety
Keephills Plant Office, Box 1, Site 4, RR1
Duffield, AB, T0E 0N0
Telephone: (587) 763-5463
Fax: (780) 797-5364
E-mail: greg_milne@transalta.com

PUBLIC NOTICE

TRANSALTA CORPORATION – SUNDANCE THERMAL ELECTRIC POWER PLANT

ENVIRONMENTAL PROTECTION AND ENHANCEMENT ACT

NOTICE OF APPLICATION

In accordance with the *Environmental Protection and Enhancement Act*, TransAlta Corporation has applied to Alberta Environment and Parks for a renewal of the existing approval for the continued operation of the Sundance Thermal Electric Power Plant with a total gross generating capacity of 2,293 MW. The plant is located in Section 20, Township 52, Range 5 West of the 5th Meridian, approximately 56 km west of Edmonton.

A directly affected person may provide input into certain regulatory decisions, as allowed by the *Environmental Protection and Enhancement Act* (section 73). Specifically, any person who is directly affected by this application may submit a written statement of concern within 30 days of the date of this notice to:

Alberta Environment and Parks
Regulatory Approvals Centre
Main Floor, Great West Life Building
9920 – 108 Street
Edmonton, Alberta T5K 2M4
Fax: (780) 422-0154
Email: esrd.epeaapplications@gov.ab.ca

The written statement of concern should include the following:

- the application number (031-9830)
- describe concerns that are relevant to matters regulated by the *Environmental Protection and Enhancement Act*
- explain how the filer of the concern will be directly affected by the activities proposed in the application
- the municipal address and/or legal land location of the land owned or used where the concerns described are believed to be applicable
- state the distance between the land owned or used and the site in the application
- contact information including the full name and mailing address of the filer. Please provide a telephone number and/or email address for ease of contact.

Environment and Parks will review each written statement of concern, seek more information if needed, and notify each filer by letter of the decision to accept or reject their written submission as a valid statement of concern.

Statements of concern submitted regarding this application are public records which are accessible by the public and the applicant. Failure to file a statement of concern may affect the right to file a Notice of Appeal with the Environmental Appeals Board.

Copies of the application and additional information can be obtained from:

TransAlta Corporation
Attention: Greg Milne, M.Sc., P.Eng.
Manager, Environment, Health & Safety
Sundance Plant Office
Box 1, Site 4, RR1 Duffield, AB, T0E 0N0
Telephone: (587) 763-5463
Fax: (780) 797-5364
E-mail: greg_milne@transalta.com

RCMP Beats

Continued From Page 9

Rural

12. July 4 – Area of Township Road 522 and Range Road 271 – Theft of Batteries

13. July 6 – Area of Township Road 544 and Range Road 22 – Theft of Lawn Tractor, John Deere 100 series

14. July 7 – Area of Township Road 531 and Range Road 15 – Theft of Trailer, 2010 white KZ-Spree 240

15. July 8 – Area of Township Road 512 and Range Road 20 – Theft of Vehicle, 2007 white Ford F350

16. July 9 – Area of 47 Avenue and 47 Street, Onoway – Break and Enter to Garage, tools stolen

17. July 10 – Area of Township Road 514 and Range Road 274 – Theft of Vehicle, 2012 white Nissan Titan

Stony Plain/Spruce Grove RCMP remind you not to make it easy for thieves. Reduce your chance of being a victim of vehicle theft. Lock your doors, do not leave a spare set of keys in the vehicle, and use a theft deterrent device to lock the steering wheel.

The Spruce Grove / Stony Plain Drug Section Information Tip Line is 780-968-7212. Anyone with drug information is asked to call and leave a message.

If you have information regarding any of these crimes, or any other crime, please call the RCMP At 780-962-2222 or 780-968-7267. You can also call Crime Stoppers at 1-800-222-8477 or text the keyword TIP205 (TIP250 for Edmonton Metro) & your Tip to CRIMES (274637)



LOSE WEIGHT WITH THE HEALTHIEST COFFEE ON THE PLANET!



HELPS CONTROL APPETITE TO LOSE WEIGHT



HELPS PROMOTE HEALTHY BRAIN FUNCTION



TASTES AMAZING!

PREVAIL SLIMROAST

Formulated with natural appetite suppressants, feel good ingredients and detox components SlimROAST is a great addition to your weight SlimROAST will produce exciting results, but you will love the taste of this delicious Italian dark roast coffee.

GREAT FOR:

- › Controls appetite
- › Regulates sugar absorption
- › Regulates fat absorption
- › Promotes brain health and focus
- › Elevates mood
- › Antioxidant



MANAGING YOUR WEIGHT NEVER TASTED SO GOOD!



ALL NATURAL



PROPRIETARY FORMULA



HEALTHY WEIGHT MANAGEMENT

PREVAIL TRIM

Formulated with natural appetite suppressants and ingredients to help detoxify your body, Prevail Trim is a great addition to any weight management program.

And as if helping to manage your weight in a healthy way were not exciting enough, just wait until you taste this delicious drink!

You will LOVE it!



BE HEALTHY! FEEL ALIVE!



PREVAIL IMMUNE BOOST

- › PACKED WITH ANTIOXIDANTS
- › SUPPORT IMMUNE HEALTH
- › VITAMINS AND MINERALS



PREVAIL ENERGY

- › WORKS IN MINUTES
- › BOOSTS ENERGY
- › LASTS FOR HOURS

www.ValentusTour.com/Ladybug

(780) 907-8642

**Town & Country
Funeral Services**

† Cemetery Monument
Sales & Installation

† Traditional Burial &
Funeral Services

† Pre-need Funeral
Packages

† Crematorium &
Memorial Services

Wabamun
780-983-2749
Evansburg
780-727-2791



Apollo Concrete

"Our business is your foundation"

**Ready Mix Concrete
Commercial, Residential, Agricultural**

Phone: (780) 848-7766
Toll Free: (866) 948-7766 Fax: (780) 848-7795
Todd@Warcon.ca

MARIJUANA

Submitted by Jim Eglinski, MP – Yellowhead

The Liberals have created a task force to study the legalization of marijuana. Within five months this task force will have to assess the potential legal, financial, moral and medical ramifications of legalizing the drug.

At the recent Conservative Policy Convention, we passed a resolution stating, "...in order to expand the means which law enforcement authorities have at their disposal to combat drugs and their negative impacts, particularly among young people, and to reduce the volume of judicial proceedings, we recommend that peace officers be enabled to issue tickets for simple possession of small quantities of marijuana."

Our policy resolution is in line with recommendations from the Canadian Association of Chiefs of Police on the marijuana file. They support providing front-line officers the ability to ticket individuals found with 30 grams of marijuana or less. The Canadian

Association of Chiefs of Police do not recommend the legalization of marijuana.

As a former RCMP officer, I have serious concerns about a number of issues regarding the Liberal's promise to legalize marijuana. How are the Liberals going to address the current proliferation of illegal, unregulated marijuana dispensaries (in Vancouver, there are currently more illegal marijuana dispensaries than Starbucks locations)? How will they address the public safety issue of people driving and operating heavy equipment while high, or ensure that marijuana is kept out of the hands of children? Will they balance our international obligations regarding the legality of marijuana?

I do not have confidence in the Liberals to put forward a plan to legalize marijuana that will adequately address all of these serious concerns. Justin Trudeau and the Liberals have made a complete mess of the marijuana issue by their failure to provide any policy coherence whatsoever.



GROVE HEALTH
Supplements & Foods

Located in the 360° Wellness Center (Beside McDonald's)
Unit 200, 300 St. Matthews Ave,
Spruce Grove, AB
587-286-0035
www.grovehealth.ca
info@grovehealth.ca



- Organic Produce & Groceries
- Non-GMO Products
- Gluten Free Alternatives
- Aromatherapy
- Kombucha Drinks
- Local Grass-Fed Meat, With No Added Hormones or Antibiotics
- Environmentally Friendly Household Items

- Toxin-Free Baby Care
- Non-Toxic Cosmetics
- Healthy Snacks & Bars
- Supplements
- Specialty Food

Visit our website for more information and to sign up for our newsletter.

Monday to Thursday 9am to 8pm, Friday 9am to 6pm, Saturday 10am to 6pm, Sunday - closed

Bring this ad in to redeem for **20% OFF*** supplements & body care, and **10%* OFF** grocery items.

*non-sale items only. Not valid with other offers. Ad must be surrendered for discount. Expires August 31, 2016

BLUEBERRY

•BLUEGRASS & COUNTRY•

MUSIC SOCIETY FESTIVAL

JULY 29, 30 & 31, 2016
 Heritage Park, Stony Plain

Sunshine: Outside | Rain: Under the Roof. Bring Lawn Chairs!



Friday - July 29

Time	Performance
2:00 pm	Alberta Society of Fiddlers
3:00 pm	Metis Child & Family Jiggers <i>Metis Affix & Egan Myhre</i>
4:00 pm	Young Medicine
5:00 pm	Supper Break
5:45 pm	Opening Ceremonies
6:00 pm	Bluegrass Band Contest
9:00 pm	The Po' Ramblin' Boys

Performers & schedule subject to change without notice

Saturday - July 30

Time	Performance
10:30 am to 11:30 am	Workshops <i>See the festival program for times & locations</i>
12:00 pm	Dirt Road Angels
1:15 pm	Chris Jones & The Night Drivers
2:30 pm	The Po' Ramblin' Boys
3:45 pm	Canadian Music Legends
5:00 pm	Supper Break
6:00 pm	David Pamley & Cardinal Tradition
7:15 pm	Bluegrass Etc.
8:30 pm	Jerry Douglas Presents... The Earls of Leicester
10:00 pm	Frank Solivan & Dirty Kitchen

Performers & schedule subject to change without notice

Sunday - July 31

Time	Performance
10:00 am to 11:30 am	Ol' Time Gospel Hour
11:45 pm	Canadian Music Legends
1:15 pm	David Pamley & Cardinal Tradition
2:30 pm	Dirt Road Angels
3:45 pm	Bluegrass Etc.
5:00 pm	Supper Break
6:00 pm	Jerry Douglas Presents... The Earls of Leicester
7:45 pm	The Po' Ramblin' Boys
8:30 pm	Frank Solivan & Dirty Kitchen
9:45 pm	Chris Jones & The Night Drivers

Performers & schedule subject to change without notice

Weekend Passes and Single Day tickets will be available at the festival gate throughout the Festival!

Admission: 3 Day Pass - \$160 | Day Pass - \$65. Kids 12 & under admitted free with an adult.

Rough Camping is \$20/night (starting from the day you arrive)

For More Info: www.blueberrybluegrass.com or call 1-888-915-4973

JULY 22ND AUCTION

FOR: RETIRING SENIORS AND BUSINESS

Located: BARRHEAD RODEO GROUNDS

Friday Evening, July 22nd at 5:00P.M.

STARTING AT 5 PM MANY GOOD AND QUALITY ITEMS: * Antique Wood Frame Parlour Setee and Matching Chairs w/styled legs, crochet seats & backs, and cast lamps * New Security System w/8 cameras * Like New Push Lawn Mower * Many more like new & interesting items * Lots of other good lawn mowers, rototillers, trimmers, edgers, tools * Patio Furniture & Yard Decor * Complete/Good Office Furniture - 36x72 Desk, 36x72 Table, 2 of 36x96 Wood Bookcases, chairs, storage cabinets, organizers, art books * Lunch Room - coffee makers, food containers & steam cook items * Many household items including - fridge, stove, washer, dryer * Leather Love Seat Recliner * Variety of Furniture * Nice Cabinet Stereo * Modern/newer Stereo System w/400 W Surround Sound

FOLLOWED BY FIREARMS: * Lakefield 64B/SA/22 LR w/Bosh Sportsview * CIL (401/SB/410 ga/3 in/FC) (402/SB/12 ga/2 3/4 in/FC) * Cooley 840/SB/12 ga/3 in/FC * Star 177 pellet gun * Kawaguchi 1270/12 ga/2 3/4 in/SA/V Rib * Lake Moss 500 A/12 ga/3 in/Pump/V Rib * Gun Safe

AT APPROX. 6 PM CLOSE OUT SALE OF TIRE SHOP: * FMC Dual Power Mag Tire Machine * Older Coats Tireman Air Tire Machine * Rim Clamp Tire Machine w/helper arm * Fluid/Calcium Pump w/hose - used 6 times * Spoons, bars, hook bars, bead hammers, slide bar/bead breaker * NEW (22.5 LX 16.1 R3 Galaxy) (13.6x16 FS Turf) (12x16.5 Hi Way 12 Ply) * New Recaps (1 @ 9Rx22.5 Grip) (2 @ 10R-22.5 Grip) (3 @ 12Rx22.5 Smooth) (3 @ LT 235x80 R17 AT) * 305/480 45-17 Baler Tire * Plus (Set of LT 245 75R 16 on Rims) (Set of 35x12.50 R15Lt on rims) (235 55R19) (235 60R18) (235 55R17) * USED/GOOD (20.8x38 GY) (2 G288 1100x24.5 G Year on Alum) (20.8x38 FS) (2 of 11Rx22.5 Grip) (31x13.50x15 Baler) * 4 of 16' Chains w/Boomers * Maxus 1.3 hp/5 gl Air Comp * 5 hp Eltc 2500 PSI Pres Washer * More Hand Tools * Norco 10 Ton Porta Power Kit * 4 General 245/75R16

AT APPROX 6:30 PM: * Ferguson 35 Tractor w/gas, 3 pt, FE Loader * NH 688 Rnd Baler * White 14x7 Cargo Trailer w/2 @ 3500 Axles, privacy toilet in front for hunters * Trucks (99 Chev 3/4 Ton w/2WD, Reg Cab, Red, 324k kms) (94 Chev Ext Cab w/L/Box, 4x4, black, 188k kms) * Truck tool & Jockey Boxes, H/Ache Racks * Variety 2" Pipe, 5/8 Sucker Rod * Cedar Boat * 2 Plastic Stand Up Toilets or Porta Potties

AT APPROX 7 PM VERY CLEAN/WELL MAINTAINED: * 2006 Chev Uplander LT w/(143k kms), green/grey * 2005 Ford 500 Sedan w/(257k kms), dark blue

JULY 27TH AUCTION

FOR: ANATOLI FROESE (674-1270)

Located: From Barrhead Ford 2 mi N, then approx
10 1/2 mi NW on Hwy 33 to TWP 610, then 1 W

Wednesday Evening, July 27th at 6:00P.M.

SPECIAL EQUIP/GOOD ITEMS: *Vertec VT 5000 Grain Dryer w/5 million BTU, 36'x6" Eltc Input Auger, 41'x6" Eltc Output Auger * Metal bins (Butlar 3 Ring) (Twister 4 Ring) * 60'x10" Auger w/pto drive, hyd swing * 15'x4" Eltc Auger * 10' Hyd Drill Fill Auger * Agsco Liquesphere 11 Seed Treater * New (2 of 38/34 Spacers for duals) (Axle Cones for JD 9400) * HD Tow Cable * Light Cable * 27' CCIL 807 dt Cult w/hyd wings, anhydrous lines * 20'x16" Metal Sides for Trailer * Cement Patio Wall & Floor Blocks

LIVESTOCK EQ/YARD ITEMS/SKI-DOO/FARM ITEMS: *2 good Power Poles * 150 of 7' Sharp Posts * Hoskins Auto Stock Waterer * 2 Cattle Oilers * Truck Chassis w/14 Bale Pipe Deck * Extra Truck Chassisw/14 Bale Pipe Deck * Extra Truck Chassis & 10:00x20 Tires * RT Wagon * 2 of 300 Fuel Tanks w/Stands * Hyd Cyl, Tarps, 18.4/15-30 Tire, 2 of 4' Mulchers, Conduit Pipe * HD Propane Camper Stove * Polaris XTRA Lite Snow Mobile, needs hood * Fair 8x12 P/Wood Shed

PARSONS AUCTIONS LTD.

Charles 674-7704 (780-674-3929) Jeff 305-4328
Pictures Available on: parsons-auctions.com

Classified Ads - Call 962-9228

Classified Policy

CLASSIFIED RATES INCLUDE GST. 1st 20 Words: First Insertion = \$6.00; Subsequent insertion = \$3.00 each. Each additional word is 20 cents per word, per insertion. Ads must be paid in advance either by cheque, cash, Visa or Mastercard. DEADLINE: is Thurs. 4:00 pm (Wed. 4:00 pm on long weekends). Classified ads may be called in to the COMMUNITY VOICE office at (780) 962-9228, emailed to: classifieds@com-voice.com, dropped off at Onoway Registries, or mailed with your ad and payment to: COMMUNITY VOICE, BAG 3595, SPRUCE GROVE, AB T7X 3A8. Ads may also be placed on the web at www.com-voice.com/classified.htm

Hall Rentals

Bright Bank Hall, 963-6835

Camp Encounter, Vincent Mireau - Camp Director. director@campencounter.com. C: 780-504-2012 W: 780-967-2548

Darwell Hall, 780-721-2690

Darwell Seniors, 892-2457

Duffield Hall, 892-2425 or 963-6887

Entwistle Community League Hall, Contact Cheryl at 780-727-6671 or Verna at 780-716-2304.

Entwistle Senior's Drop In Centre, Barb 727-2108 or Glennis 727-4367 Mon-Fri

Evansburg Senior's Heritage House, Flo 727-2496 or Marcel 727-4269

Evansburg Legion, upper hall 250 people, lower hall 80-100 people, 727-3879

Fallis Community Hall, 892-3150

Keephills Hall, 731-3761

Lake Isle Hall, 892-2481

Lake Romeo PeaVine Hall, 785-2700

Magnolia Hall, 727-2015

Manley Goodwill Community Hall, 963-9165 or 916-0146

Mayerthorpe Diamond Centre, 786-4044

Moon Lake Community Hall, Nikki Berg 780-898-1390

Park Court Community Hall, 727-4476

Parkland Village, 960-3673 or 960-5556

Rich Valley Community Hall, 967-3696 or 967-5710

Rosenthal Community Hall, 963-7984

Seba Beach Heritage Pavilion, 797-3863

Smithfield Community Hall, 892-2390

Tomahawk & Dist Agra Center, 898-3443

Classified Ads - Call 962-9228

Wabamun Jubilee Hall, 892-2699.
 Wildwood Community Hall, 325-2692 or 325-3749
 Wildwood Rec Complex 325-2077 or 514-8944
 Wildwood Senior's Hall, 325-2030

Obituaries

Bruce Leyden February 9th, 1946 - June 27th, 2016 Son of Lloyd and Ruby Leyden originally from Edson and Entwistle, Bruce leaves to mourn his wife Elsie, siblings Norma, Denis, Margaret and Lloyd, his daughter Melanie and son Bradley and his granddaughters, Emma and Abby, and many relatives and friends. A Celebration of Life was held in Edmonton July 6th 2016 (1) 19-07



Linda Dianne Mattice 1952 - 2016
 During the early hours of Wednesday, July 13, 2016, Linda Mattice of Entwistle, Alberta passed away at the Drayton Valley Hospital and Care Centre at the age of 64 years. Linda was a very strong, independent and hardworking woman; spending many years as a cook, and then as a butcher from her home-based business. Over the years, Linda made many strong connections and surrounded herself with warmth and love of family and friends. Linda will always be lovingly remembered by her husband, Robert "Bob";

children, Reg (Carol), Shirley and Bobby (Jenn Chik); grandchildren, Ryan, Dylan, David, Elizabeth, Grace and Ted; brothers, Bill, Perry (Mary Lou), Cameron and Dean (Anne); sister, Donna (Brian) Baumann; half-sisters, Jackie Flanders and Gerry Epp, as well by several extended family and many wonderful friends. Linda was predeceased by her parents, Gordon and Agnes May and half-brother, Gordon

May. In honour of Linda, her life will be celebrated at Entwistle Community Hall, 4921 51 Street, Entwistle, Alberta on Saturday, July 23, 2016 at 1:00 p.m. The Mattice family wishes to extend their heartfelt appreciation to Dr. Gossmann of Claro Family Practice, Drayton Valley and the staff at Evansburg Health Centre for the wonderful care provided to Linda during her illness. For those who so desire, memorial

contributions in Linda's name may be made directly to Drayton Valley Health Services Foundation - CT4DV, 4550 Madsen Avenue, Drayton Valley, Alberta T7A 1N8. Condolences may be sent to www.serenity.ca.

SERENITY FUNERAL SERVICE
 DRAYTON VALLEY
 780.542.3338
www.serenity.ca
 (1) 19-07



UNRESERVED BANKRUPTCY

AUCTION

DATE: TUESDAY, JULY 26, 10 A.M.
SITE: 8400 - 18 STREET, EDMONTON
PREVIEW: MONDAY, JULY 25, 11 A.M. - 5 P.M.

FURTHER TO INSTRUCTIONS FROM MNP LTD. TRUSTEE IN BANKRUPTCY FOR

GOODWIN HEAT TREATING LTD.

PLUS EQUIPMENT FROM A JOB SHUT DOWN AND A VARIETY OF PERSONAL BANKRUPTCIES

*** HEAT TREATING FURNACES AND TESTING EQUIPMENT ***
*** WELDING EQUIPMENT * TOOLS * VEHICLES ***

FEATURING
 THIS AUCTION WILL BE ONLINE VIA BIDSPOTTER AND LIVE
FEATURING

GAS GENERATOR: LINDBERG ENDOTHERMIC GAS GENERATOR MODEL 16-1500-A4-HYEN
HEAT TREATING: PARK THERMAL NATURAL GAS CAR BOTTOM FURNACE * SALT POT HEAT TREATING * 5- PARK THERMAL HEAT TREATING FURNACES * VEHICLES: * 2008 MACK MODEL CHU 613 T/A HIGHWAY TRACTOR * 2015 DODGE 1500 LARAMIE, 4X4, SHORT BOX, CREW CAB, 25,000 KM. * 2013 FORD F-150 XLT, 4X4, SHORT BOX, CREW CAB, 90,000 KM. * 2008 CAN-AM SPYDER MODEL A-186, 990 C.C., 19370 KM. * PALLET JACKS * 2014 CERTIFIED CAR HAULER TRAILER * 20' SEA CONTAINER * 15 SECTIONS OF AS NEW SCAFFOLD (10') * 2006 HYSTER H50FT 4800# FORKLIFT * BAKERMODEL FCJ040 4000# FORKLIFT * SCALES * SANDBLASTING * COMPRESSORS * HARDNESS TESTERS * WELDING EQUIPMENT * HAND AND POWER TOOLS * EZRECT SHELVEING * PALLET RACKING * PLUS LOTS OF MISCELLANEOUS

SEE WEB PAGE FOR UPDATES *

SUBJECT TO ADDITIONS AND DELETIONS * EVERYTHING SOLD AS IS, WHERE IS WITH NO WARRANTIES OR GUARANTEES OFFERED OR IMPLIED. * CASH * VISA & MASTERCARD TO \$3,000 WITH NO NO CREDIT CARD FEES, 3% OVER \$3,000 * BANK DEBIT CARD * CERTIFIED CHEQUES WITH CASH DEPOSIT SALE DAY * CHEQUES WITH LETTER FROM BANK GUARANTEERING PAYMENT * SETTLEMENT ON SALE DAY, NO EXCEPTIONS!!! * 10% BUYERS PREMIUM ON ALL LIVE PURCHASES, 15% ON ALL INTERNET PURCHASES *

FOOTHILLS

EQUIPMENT LIQUIDATION CO. LTD.
 22355C WYE ROAD, SHERWOOD PARK, AB, T8C 1H7
 PHONE (780) 922-6090 FAX: (780) 922-6248 WEB: www.foothillsauctions.com

AUCTIONS APPRAISALS LIQUIDATIONS

Groundsman Required

EQUS, Canada's largest member-owned utility, has an opening for a Groundsman to work from our Onoway location. Duties include helping with the clearing of trees and other vegetation from close proximity to our electrical power lines. You would perform physical work outdoors in all weather conditions. **Closing Date: July 22, 2016**

We require a high school diploma, plus experience in outdoor physical work. Experience with chain saws and related equipment is an asset, as is a Class 5 Driver's license with air endorsement.



WESLAND MODULAR HOMES
Locally Owned and Operated since 1997

Proudly Serving Central and Northern Alberta!
Prices Starting at \$120 per square foot!!
We are now doing ICF Foundations, Decks and Garages!!

www.weslandmodular.com
Office: 780.727.3735
Toll Free: 1.877.727.3224
lucas@weslandmodular.com

Redeem this Coupon for \$500 off the Price of Your Next Home!!
(Some restrictions apply, ask for details)

"Quality Custom Modular Homes at an Affordable Price!"

Classified Ads

Garage Sales

HUGE MULTI-FAMILY GARAGE AND ESTATE SALE!!! RR 25 Hiway 43 (5 km north of Onoway turnoff) Entire household contents, antiques, never used items, large selection of Jim's Jigs discontinued tackle. Something for everyone!! Rain or shine as it is being held in a large shop. Thursday, July 28th (3 p.m. - 7 p.m.) Friday, July 29th - Monday, August 1st (9 a.m. - 5 p.m.) (2) 19-07

Employment Opportunities

Part time help needed for daily home care of elderly man. Your availability is a consideration, as more than one person will be needed to cover 7 days @ 4 hrs. am: Bathing, dressing, moving some equipment,

some meal preparation. Send me some details of your work history and your phone # to Box 95 Entwistle .T0E 0S0 (3) 19-07

Services

Best-Cistern-Septic-Solutions. Cistern and Septic Inspection, Cleaning and Repair! New Installs Available. Plastic, metal, fiberglass or concrete. We clean them all! Your cistern will be vacuumed, cleaned and sanitized with our high pressure, hot wash, sanitizing system. Reasonable Rates, Call 780-668-4306 (5) 19-07 OG

Computers

FREE COMPUTER CHECKUP, Repairs not over \$50. Laptop for sale \$125. Ind. lessons for seniors and beginners. 780-892-4993. (19) 15-03

GROVE HEARING CLINIC

Hear what you've been missing...

960-2960
1-866-960-2960

Senior Discounts



Full Service & Repair

Full Hearing Assessments

HOURS OF OPERATION: 9am - 5pm Weekdays

3rd party billing (AADL, WCB, DVA, FCH) • Personal 0% Financing if Needed

For The Latest Technology In Hearing Aids & Assisted Living Device Stop By & See Dawn

#220-70 McLeod Ave - Westland Market Mall, Spruce Grove



Noreen Hutt www.noreenhuttorealestate.ca
REALTY EXECUTIVES
LEADING 4922-50TH Ave. Evansburg, AB
780-727-2887 
 780-962-9696 

*Serving the
 Evansburg, Entwistle,
 Wildwood, Seba Beach,
 Yellowhead County &
 Parkland County Areas.*

"Your Local Realtor"



NEW

Great Find! This 3 Bedroom Home Located Downtown Has an Updated Kitchen & Bathroom, a Sunroom, & a Full Basement! **\$119,900**



10 Acres With a Creek! This Acreage Has the Majority of the Land Open and a Treed Area Next to the Creek Which is a Perfect Building Site or Weekend Retreat! **\$87,500**



Newly Updated 3 Bedroom Home With a Full Basement Nestled in the Trees on 11 Acres Shows a "10". Extras Include an Attached Garage, Huge deck, Firepit Area, Small Barn, and Some Game Fencing! **\$367,500**



Gorgeous Family Home With a Finished Basement on a Large Fenced Lot! Features are a Stunning Kitchen With Rich Cherry Cabinets and Large Dining Area, a Bright and Open Living Room, 5 Attractive Bedrooms, 2 Full Baths-1 With a Large Soaker Tub & 1 With a Double Shower, a Second Kitchen, a Double Attached Garage and More! **\$339,000**



What a Deal! 3 Bedroom Home With Addition, Carport, and Double Car Garage. **Only \$56,500**



Right Off Pavement, 7.34 Acre Property Only Minutes From Evansburg Has a 3 Bedroom Mobile Home on a Finished Partial Basement. Extras Are a Double Car Garage With In Floor Heating and is Located Just West of Evansburg! **\$195,500!**



Great 5 Bedroom Family Home With a Finished Basement Features an Open Kitchen, a Bright Living Room, Two 4 Piece Baths, a Family Room, a Front and Back Deck, Fenced, a Garage, and Close to Schools! **\$235,500**

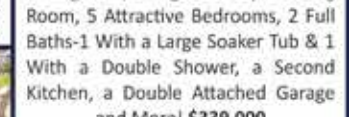

This Attractive 1217 sq ft Home Features a Huge Country Kitchen, a Bright Living Room, 3 Bedrooms, & 2 Baths. Extras Include a Newer Deck, Great Landscaping, a Garden Spot, 2 Sheds & Fenced Yard **\$169,900**



160 Acres of Amazing Recreational Property With an Enormous Spring Fed Dug Out, Adjoining Crown Land, Mature Trees, Fenced, & Minutes to Town! **\$175,000**



Incredible! This Attractive Home Features a Huge Kitchen, an Inviting Living Room, 5 Bedrooms, a Rec Room, 2 Baths, Finished Basement, a Large Deck and a Garage! **\$239,900**



Located in The New Subdivision in Evansburg Complete With Walking/Bike Trails is This Perfect Residential Lot To Build Your New Home On. **\$29,900**



Deluxe 4 Bedroom Home With a Finished Basement on a Double Lot. Features are a Large Kitchen, an Open Living Room, a Rec Room, a Family Room, a Carport, a Double Car Garage, Privacy fenced, RV Parking, and Has a Paved Driveway! **\$289,500**



Incredibly Priced Updated Home on a Fenced Lot Features a Large Country Kitchen, an Attractive Living Room, 3 Bedrooms, a 4 Piece Bath, 2 Decks, a Storage Shed & Close to Schools! **\$98,500**

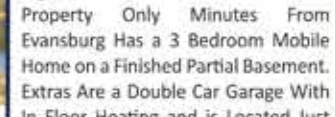

This 3.53 Acres is Close to The Lake In Singing Hills Estates. This is a Great Weekend Getaway or Perfect Building Spot! **\$85,000**

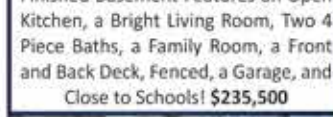

This Newly Updated Victorian Home Has a Bright and Open Living Room, 2 Bedrooms, an Updated Kitchen, a New Bathroom, and a Loft. Extras Are New Shingles, Stucco, Paint, Windows, Fixtures, and Flooring! **\$139,900**



This Amazing 153 Acres of Lakefront Property is Great For Fishing, Boating, Swimming, Watching Wildlife, & Going on Nature Walks! **\$148,500**

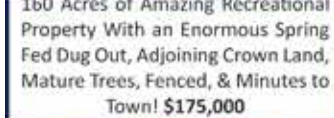

5 Bedroom Home With a Full Basement on .49 acres Has a Large Kitchen, a Spacious Living Room, and a 4 pce Bath! **\$73,000**



Newly Built Home With a Full Walk Out Basement on 9+ Acres. Features are a Bright and Open Floor Plan, Vaulted Ceilings, Maple Flooring, A Beautiful Kitchen With a Large Island, a Bright and Spacious Living Room, 4 Bedrooms, a 4 pc Bath, a Huge Rec Room, 2 Decks, a Double Garage, Fenced For Horses and Right off Pavement! **\$359,900**



Beautiful Home on 1.44 Acres Right in Town Has 5 Spacious Bedrooms, 4 Bathrooms, a Huge Oak Kitchen, a Separate Dining Area, a Den/Office, a Living Room Complete With a Fireplace, a Rec Room an Attached Garage, 2 Covered Decks, and a Paved Driveway. Also Included is an Older 2 Storey Home and a Garage! **\$399,900**



This Completely Updated Home With a Finished Basement Features a Huge Kitchen With New Countertops & Backsplash, an Attractive Living Room, 4 Spacious Bdrms, Rec Room, & 2 New 4 Pc Baths. Extras Include Custom Tile Work, New Windows, Flooring, Fixtures, Stucco, Etc., & a Double Car Garage With Power & a Cement Floor! **\$215,000**



Located in Entwistle at the Gateway to the Pembina Provincial Park and Right Off Hwy16 enroute to the Jasper National Park is the Perfect Spot For Your Own Antique Store or Other Retail Business. On a Double Lot on the Corner of Main Street is The Perfect Location For Starting Your Own Business! **\$279,900**

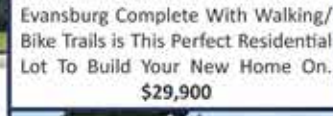



Vision Realty
Serving: Parkland, Yellowhead County, Evansburg,
Entwistle, Wildwood & Surrounding Area
(780) 542-4040



Chuck Friesen
780-898-1613
chuckfriesen.com

\$1,250,000



MLS E3405126 / 7419 TWP 494
Pride of Ownership! 76 Acre Horse Ranch with 1372 sq ft house, 12,600 sq ft Indoor Arena, Barn, Stalls, Pens & Hay land. This is a must see! Call Chuck 780-898-1613

Classified Ads - Call 962-9228

Meat/Produce

Grace Gardens Saskatoons & Raspberries. 4 L pail: U-Pick/\$12, We-Pick/\$24. Calahoo Area, Call Tracy for picking time: 780-967-3587 or cell 780-405-8371 (3) 19-07

Firewood

Firewood For Sale: Birch, Spruce, Pine, Poplar. Cords, Partial Cords, Bundles, Split, Seasoned, Cleaned. Pickup or Delivery, Woodchuck Firewood. Call 780-288-7247 (13) 03-05

Vehicles



2013 Ford Taurus Sel AWD, Moon roof heated leather seats command start Back up alarm,90,000 km. \$16,000 OBO Call 780-305-7077 (4) 21-06

Miscellaneous

Will Pull Away for Free, unwanted travel trailers to my farm use, also good burning barrels and rain barrels \$15 each. Call Steven 780-967-2779 (8) 19-07

Lil' Mule Logging Inc. Now buying Poplar/Black Poplar, Minimum 20 Acres. Call Shawn 403-318-4346 (2) 26-07 OG

For Sale

Round oak table, 2 pressed back chairs, metal step rails, open (Neon) sign, 25 cement block, other furniture and collectables. 780-325-2379 (1) 19-07

<p>\$345,000</p>  <p>NEW MLS E4026461 5.97 Pretty acres on the edge of Tomahawk! 2008 Modular over 1200 sq ft, 3 bdrms, A/C, HUGE deck. 2 bay oversized garage. Call Debra 780-621-8067</p>	<p>\$579,000</p>  <p>MLS E4005964 51004-RR73 Beautiful home on 46 acres! Shop, barn, fencing. Home updated with lovely features. Call Debra 780-621-8067</p>	<p>\$470,000</p>  <p>MLS E4004899 80 fenced acres. Mobile with addition. Mint Condition. Shop & 24x30 garage, Oil Rev. Call Heather 780-621-8001</p>	<p>\$675,000</p>  <p>NEW PRICE MLS E3389699 40256A Hwy 13 Equestrian Facility. 153 Acres. Riding Area, Barn, House. Call Chuck 780-898-1613</p>
<p>\$200,000</p>  <p>MLS E4017619 5110 Twp Rd 500 15 fenced acres on pavement. 20 minutes East of town. Mobile home & garage. Call Chuck 780-898-1613</p>	<p>\$300,000</p>  <p>SOLD MLS E3433705 7217 HWY 624 20 Acre Acreage with shop. Just off Pavement. Call Heather 780-621-8001</p>	<p>\$200,000</p>  <p>MLS E4005293 5028 50St, Entwistle 1886 sq ft, 2 story. 4 bdrms, garage, on large lot. Call Chuck 780-898-1613</p>	<p>\$169,900</p>  <p>MLS E3405703 #614 54426 RR40 Lake Front!! 7 Acres with power, Trees, gated, private, One lot over from municipal reserve. SW Lac St. Anne. Call Heather 780-621-8001</p>
<p>\$99,900</p>  <p>MLS E3410005 4618 52 Ave. Evansburg 2005, 3 Bdrms, Large deck. Shows very well. No Property Tax. Inc. in lot rent. Call Barb 780-542-1614</p>	<p>\$294,900</p>  <p>MLS E3434035 4710 52A Ave. Evansburg 5 bedroom bungalow detached garage in cul de sac. Call Chuck 780-898-1613</p>	<p>\$225,000</p>  <p>MLS E3433755 4816 51 Ave. Evansburg 860 Sq Ft Bi-Level. 1 Year Old Home. 2 Bedrooms, Large Lot. Call Chuck 780-898-1613</p>	<p>BRAND NEW BUILDING!</p>  <p>4002 47ST Drayton Valley IMMEDIATE POSS. FREE CONDO FEES & PROPERTY TAXES FOR 2016! \$206,374 - \$390,694 Inc. GST. Call Heather 780-621-8001</p>
<p>\$219,900</p>  <p>MLS E4008345 / 5112 - 50 St. Evansburg Lots of OPTIONS HERE! Inc. in price. Building with Residence & Business with Inventory. Will consider trades-Home or Mottohome. Call Heather 780-621-8001</p>	<p>\$129,500</p>  <p>MLS E3347197 4815 54 Ave. Wildwood 1330 Sq. Ft. home. Renos & new construction. Move in ready. Call Chuck 780-898-1613</p>	<p>\$43,000</p>  <p>NEW PRICE MLS E3423384 4812 51 Ave. Wildwood Older Mobile On Serviced Lot. Call Chuck 780-898-1613</p>	<p>\$253,000</p>  <p>MLS E3396527 SE-4-51-8-W5 136 Acres West Side of Pembina River. Land Slips to River. Call Chuck 780-898-1613</p>
<p>\$79,000</p>  <p>MLS E4016117 4609 52 St. Entwistle Commercial Lot / Quarter Acre. Zoned Hwy Commercial. Services at Property Line. Call Chuck 780-898-1613</p>	<p>\$325,000</p>  <p>SOLD MLS E4008304 7201 Twp Rd 512 2002, 3 Bedroom, 3 bath. 5 Private Acres. A Must See!! Call Heather 780-621-8001</p>	<p>FOR SALE 4 COMMERCIAL LOTS IN WILDWOOD</p> <p>\$209,900 / CLS E1022518 5102 51 Ave. Ideal Work Camp! 15 Rooms With Kitchen & Laundry. Facilities Town Services, Lot Of Parking, Hwy 16A Frontage. Call Chuck 780-898-1613</p> <p>\$69,900 / CLS E1022521 5114 50 Ave. 1.3 Acre-Lot / Some Brush / Hwy 16A Frontage Services To Lot. Call Chuck 780-898-1613</p>	<p>\$255,000</p>  <p>MLS E4004399 Pretty Quarter Section, 159 Acres, backing crown land, partial clearing with seasonal creek! Call Darby 780-898-9857</p> <p>\$184,900 / CLS E1022517 5104 51 Ave. 44 Unit Covered Storage Building Built In 2006 Hwy 16a Frontage. Surveillance On Site. Call Chuck 780-898-1613</p>

CALL CHUCK FOR YOUR MARKET EVALUATION!

Classified Ads - Call 962-9228

For Rent

2 and 1 Bedroom available immediately. Large, clean & quiet in an **adult only** building. Kids allowed up to 3 yrs old, cats allowed, must have good credit. 1 bedroom \$695, 2 Bedroom \$795 - includes heat, water & parking, DD \$300. **Ivka 780-807-1300, jakovljevicivka@yahoo.ca** (2)

FOR RENT... Located in Evansburg, AB. Above Claire's V&S. Great Location on Main Street. 3 Bedroom apartment. 1,300 sq. ft. Included: Fridge, stove, washer, dryer. Because of location... We prefer working individuals... We would also prefer seniors... \$900.00 per month plus utilities. Damage deposit same... No smoking... No Pets... References may be required... Contact: Gerry Marcotte @ 780-727-2466. (2)

Great for a Small Family or Seniors. Newly renovated townhome, 2 bedrooms, den & 1.5 bathrooms in Winfield, AB. Washer & Dryer in-suite. \$850/month. Call 403-606-6977 (4)

2 Bedroom House in Evansburg. Some new floor, Fenced yard, Fresh paint, Fridge, Stove, W/D, Backs onto park, Pets Negotiable. \$995/month + Utilities, DD Same. 1 year lease, working adults No Partiers. Call 780-325-0005 (4) 28-06 OG

Real Estate



ACREAGE FOR SALE - Move In Ready. Located in Parkland County off of Highway 624. Newly painted 1176 square foot bungalow home with full basement. Three bedrooms and 1 1/2 baths. All new energy efficient windows and doors.

Comes with stove, fridge, washer and dryer. The house has brand new vinyl siding and asphalt shingles. All of this with 10 acres of land is priced to sell for \$379,900. Property also has great potential for advertising a

business. Call today at 780-339-2253 to come and view this property. (3) 28-06

NEED CASH?! We Buy: Estates & Complete Households, We Pay Cash!! 780-727-2724 (4) 05-07

Land For Sale

160 Acres @ Seba Beach, overlooking lake view. Phone 780-916-4546, Ask for Phil. (2) 05-07

Church Directory

<p>All Saints' Anglican Church Sunday Morning Worship 9 BCP 10:30 BAS with Sunday School & Nursery 5212-47 Ave, Drayton Valley (780) 542-5048</p>	<p>Seba Beach Christian Fellowship Sunday School 10:00a.m. Worship Service 11:00a.m. Weekdays Bible Study & Prayer (780) 395-3594</p>	<p>Roman Catholic Church St. Agnes Parish, Mowbray Sunday 9:00a.m. St. Elizabeth Parish, Evansburg Saturday 7:00p.m. (780) 786-2032</p>	<p>Advent Lutheran Church Sunday Worship & Sunday School 11:00a.m. Evansburg O: 727-3594</p>	<p>St. Saviour Mission (Anglican Diocese of Edmonton) Service every Sunday at 10:00a.m. Rev Coleen Lynch 5117-51 Avenue (Wakamun Seniors Center) Ph: 780-940-4733 www.stsavioursmission.org</p>
<p>St. Augustine's - Parkland Anglican Church 131 Church Rd, Spruce Grove Sunday Service 10:00a.m. Eucharist with Sunday School & Nursery All are Welcome Office 780-962-5233 www.staugustinesparkland.org</p>	<p>Parkland Baptist Church Sunday Worship Service 10:30a.m. All Welcome Pastor Norm Bleick Youth Pastor Steve Gascon 121 Brookwood Drive (780) 962-4101 www.parklandbaptist.ca</p>	<p>Immanuel Lutheran Church of Rosenthal Traditional Service 9:00a.m. Contemporary Service 10:30a.m. Christian Counseling Services Pastor Bill Flath Ry Rd 13, Top Rd 524 Ph: 780-963-4148 www.irc.ca email: offer@irc.ca</p>	<p>Stony Plain United Church Sunday Service 10:30a.m. 5022-51 Ave, Stony Plain Mewassin United Church Sunday Service 9:00a.m. Rev. Sally Boyle Hwy 627 - Ry Rd 30 Ph: 780-963-4745</p>	
<p>Emmaus Lutheran Church Sunday Worship Service 10:30a.m. Bible Study 9:30a.m. Sunday School 9:30a.m. Rev. Steven Brummett 4604-29th Ave, Drayton Valley Ph: 780-542-5201 www.emmauslutheran.ca</p>	<p>St. Anthony Catholic Church WEEKEND MASS SCHEDULE: Saturday 5:00p.m. Sunday 12:00p.m. 4708-50 Ave, Drayton Valley Parish Office: 542-5254</p>	<p>Church of God Pastor Evan Baum Sunday School 10:00a.m. (Sept-June) Worship Service Sun. 11:00a.m. Youth Fri. 7:00p.m. (during the school year) 6004-49 Street, Drayton Valley Ph: 780-542-5091</p>		
<p>Ignited Church & Ministries Pastors: Mark & Leanne Eshleman Sunday Service 10:30a.m. 4651-41 Ave, Drayton Valley (Dixie Mall on Mainland Clinic) Ph: 542-5443 ignitedchurch@telus.net</p>	<p>The United Church of Canada Sunday Worship 10:30a.m. Sunday School 10:30a.m. 3009-48 St, Drayton Valley Church Office 780-542-5743 church@telus.net www.uc.ca/20</p>	<p>St. Joseph's Catholic Church Sunday Mass 11:30a.m. Wabamun, AB</p>	<p>Drayton Valley Alliance Church Pastor John Haazen Join us for Sunday Service at 10:30a.m. Aurora School 3901-55 Ave. Programs for all ages Office at 4301-55 St, Drayton Valley Ph: 542-6502. drvaliance.ca</p>	<p>Calvary Baptist Church Pastoral Team: Lorne Trudgian & Kenton Penner Sunday Worship 10:30a.m. Youth & Ministries Info - calvbapt@telus.net 4401-39th Ave, Drayton Valley 780-542-4774 www.calvarybaptist.ca</p>

SERVICE DIRECTORY

JIM HAY TRUCKING

- Screened Black Dirt
- Beach Sand
- Road Gravel • Fill Dirt

(780) 220-5849

Western Sheet Metal Ltd.
& Mechanical Services

- Forced Air Heating • Furnace Replacements
- Gas Fitting • High Efficiency Furnaces
- Air Conditioning • New Construction

COMMERCIAL & RESIDENTIAL
(780) 514-0839
 www.westernsheetmetalhvac.ca
 service@westernsheetmetalhvac.ca

DUNN'S HEAVY DUTY REPAIR LTD.

Fully equipped mobile service truck, including welder, oil evac & 5000 lb crane.

We repair all types of heavy equipment.

- construction / mining / rock crushing equipment
- tractor trailer units • skid steers

Stephen Dunn 780-278-8525

Entwistle CONCRETE PRODUCTS LTD.
 SAND & GRAVEL SALES



Dan McCracken
Ph: 727-3525

THIS SPACE RESERVED FOR YOU!

Norm Blakeman's Drilling Ltd.

Waterwell Drilling & Servicing Pumps & Pressure Systems

SERVING LAC STE. ANNE & WEST PARKLAND FOR OVER 25 YEARS!

Joe (780) 924-3024

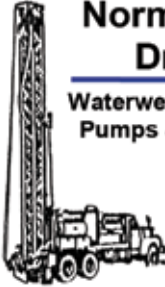

THIS SPACE RESERVED FOR YOU!

Complete Drywall Service

All types of Texture
 Insulation and T-Bar ceilings
 Minor Renovations



RAL Drywall and Plastering Ltd.
 780-691-5248

THIS SPACE RESERVED FOR YOU!

SANGUDO VETERINARY CLINIC

Box 581, 4916 - 52 Ave. Sangudo, AB. T0E 2A0

Dr. Ralf Sanders DVM

Ph: 780-785-2200
 Fax: 780-785-2228
 sangudovet@gmail.com

24 HOUR EMERGENCY SERVICE



THIS SPACE RESERVED FOR YOU!

PEMBINA CONCRETE PRODUCTS LTD.

Manufacturers of **ONE PIECE SEPTIC & HOLDING TANKS**

LAC L. A. Contracting

5" Continuous Eavestroughing & C-Can Rentals

LES 910-5472



JACK'S AUTO BODY & TOWING

- *Specializing In Collision Repair
- *Guaranteed Work
- *Insurance Claims Onoway

967-5850

Located between Alberta Beach & Onoway on Hwy 633

OUR PLEDGE IS QUALITY



* Water Cisterns * Field Systems * Pumps and Accessories * Sumps

DELIVERED TO YOUR SITE

1-800-661-3047
 780-727-2702

PembinaConcrete.com

BOX 123, Entwistle, T0E 0S0



SERVICE DIRECTORY

WABAMUN PHARMACY
I·D·A·
 Box 90, 5120 - 51 Avenue
 Wabamun, AB T0E 2K0
 Ph: (780) 892-2278 Fax: (780) 892-2488

RamRod Inc.
 Available Services for Mobile Steaming:
 • Culverts & Frozen Waterlines
 • Backhoe (Tree Removal)
 • Aerial Truck for Washing Buildings, Signs, etc.
Contact: 1.780.915.9199

ROY SHERWOOD
 Master Electrician
 Ph: 780-968-1425
 Cell: 780-908-2287
 Fax: 780-968-2211
 Email: suntech@explornet.ca
 Box 5, Site 6, RR1
 Carvel, Alberta T0E 0H0

SURETECH ELECTRIC LTD.
 Control & Automation • Commissioning
 Industrial • Commercial • Residential
 Solar Sales & Service

DONALD N. GREENWAY
 Chartered Accountant
 Suite 205 Sunrise Professional Building
 215 McLeod Avenue
 Spruce Grove, AB
 (Bus.) **962-6366**
 (Fax) **962-3990**

THIS SPACE RESERVED FOR YOU!

HAYES DENTURE CLINIC
 Patricia A. Hayes (Certified Denturist)
 Mon. - Fri. 9-5, Sat. 9-12
 *Complete & Partial Dentures *Repairs & Relines
 *All Denture Plans Acceptable
 *Home Calls By Appointment
Serving you for over 32 years!
 3A - 20 McLeod Ave. Phone
 Spruce Grove, AB 960-0227
 (North of Smitty's)

THIS SPACE RESERVED FOR YOU!

P&E VENTURES INC.
 SKID STEER SERVICES
 GENERAL LANDSCAPING POST & PILING HOLE
 SNOW REMOVAL SAND AND GRAVEL
 PAUL VAN HECKE & CURTIS MIKO
 OWNER / OPERATORS
 BUS: (780) 727-2721 CELL: (780) 621-6148
 Box 498, EVANSBURG, AB T0E 0T0

THIS SPACE RESERVED FOR YOU!

2Bros Custom Contracting Ltd.
 Custom Framing • Concrete Floors • Shingling
 Siding Soffit Fascia • Styrofoam Block System
 Jeff 780-717-0520

THIS SPACE RESERVED FOR YOU!

BREWSTER BOBCAT SERVICE LTD.
 P.O. Box 454, Wildwood, AB T0E 2M0
 * Site Preparation
 * Pile Drilling
 * Concrete Work
 * Landscaping
 * Demolition
 * Sand & Gravel Delivery
 * General Contracting
 brwcat@gmail.com
 Telephone: (780) 325-3743
Bruce Balascak Cell: (780) 621-6960

H&P Kosik CONSTRUCTION Ltd.
 Harvey cell. 780-445-8010 Box 145, Darwell, AB T0E 0L0
 ph. 780-892-3532
 No Job too small... We do them all!
 • Road Building • Black Dirt • Sand • Gravel • Clearing • Dugouts

Ernie's Repair & Service

 4820 - 47 Avenue, EVANSBURG
727-4433

MARK MARTIN PFEIFFER
 MASTER BRICKLAYER/MASON
 Cell: 780-242-3308
 Email: pfeiffer.mark@hotmail.com
 • Brickwork • Stonework
 • Rockwork • Parging
 • Concrete Block Work
 • Tile Work (all kinds)



SERVICE DIRECTORY



"We are a family orientated company that pride ourselves on SAFETY and EFFICIENCY"

CHRIS & LISA VANHILL
OWNER/OPERATOR

Site Clearing, Grading, Road Building,
Brushing, Acreage Development, Dugouts, etc.

780-619-3236
vanhillcontracting@gmail.com Onoway, AB



- Construction & Septic Installation
- Environmental Wastewater Disposal
- Site Design & Evaluation
- Power, Water & Basement Excavation
- Trackhoe, Backhoe, Bobcat & Dump Truck



For All Your Excavation Needs

Call Dan 780-991-4484 Reid 780-909-0173



Small Engine and Golf Car Specialist:
Repair | Buy | Sale

780.785.3270

12 KM South of Sangudo, on Hwy 757
www.lakeviewsmallpower.com



HEAVY TRUCK MOBILE SERVICE

1.800.940.1940 www.firstmobileservice.ca



11313 - 170 Street, Edmonton, AB T5M 3P5
Ph: 780.413.8800 www.firsttruck.ca

THIS SPACE RESERVED FOR YOU!



Real Property Appraisals

Residences, Rental Properties up to a 4-Plex,
Acreages, Vacant Land up to 160 Acres

Financing, Divorce, Estate Settlement,
Subdivision, Insurance Claims

Don George BA, DAR / CNAREA
Real Property Appraiser & Certified Appraisal Reviewer
Coldstream Property Appraisals Inc.

CELL/WK: 780.237.1646 FAX: 780.665.7177
email: appraisals.dgeorge@gmail.com

Forage Harvesting

Chopping - Hauling - Bagging



Onoway, AB
Ron (780) 967-3017
Steven (780) 983-7993



Shirley Mazeppa
Dog Grooming

Please call for an appointment
780-727-2845

8007 Highway 16A
Evansburg, AB



JOANNE HAY
Broker/Owner

Buying, Selling, Just Thinking About It?
Call me, I'm at Home in your neighbourhood!

(780) 892-4440 joanne.countryside@gmail.com



**AVOID THE RUSH
BOOK NOW FOR YOUR 2016
VINYL DECK INSTALLATION**

We can help you no matter what your construction needs:

- Custom Exteriors - Doors, Windows, Siding, Soffit, Fascia
- Renovations - Kitchen, Bath, Basement, Additions
- Custom Decks and Railings
- Manufacturer Trained Vinyl Deck Membrane Installer
- Water Feature Design and Creation
- Garage, Workshop, Gazebo, Pergola Construction
- Final Grade
- Commercial Fit-Up and Renovations

Phone: (587) 990-8838
www.kingbrosqualityconstruction.ca

THIS SPACE RESERVED FOR YOU!





10% OFF Commercial / Office Buildings

- Competitive Pricing
- No Job Too Small

**Call Today for your FREE Quote!
(780) 264-7740**

SERVING SPRUCE GROVE, STONY PLAIN AND EDMONTON SINCE 1995



Water well drilling and service
Family owned Business Serving Alberta since 1917



Tired of hauling water?
We can install a water well with a permanent water supply for as little as \$150/month OAC

- Never run out of water again!
- 5 year workmanship warranty
- 3 Convenient ways to pay
 - Visa
 - Mastercard
- We now offer full financing

Stop in at our office 4405 - 50 Street, Stony Plain
780-963-1282
admin@summersdrilling.com



EdmontonLakeProperty.com

• Find Every Property For Sale! • Free Property Evaluations!



**Unbelievable LAKE FRONT!
SOLD IN 15 DAYS!**

\$689,900



Panoramic LAKE WABAMUN View!

SOLD IN 12 DAYS!

\$549,900



**Vacation At Home!
SOLD IN 25 DAYS!**

\$274,900



**Traditional LAKE FRONT!
SOLD IN 13 DAYS!**

\$204,900



LAKE SIDE Ponderosa!
Experience Lake Country living in this hand-hewn Aspen Log, 2 storey stunner with majestic ceilings, 3 bedrooms, in Jones Beach.

\$369,900



Sought After LAKE FRONT!
Quality LAKE FRONT home on prime Lake Wabamun shoreline in Seba Beach! Rich décor with fir beamed ceilings, and top finishings.

\$749,900

NEED IT DONE FAST! CALL WAYNE.



Ultimate LAKE FRONT!
Breathtaking natural beauty indoors and out, at this spectacular 2,744 sq. ft. 2 storey on private Lake Wabamun Water Front!

\$1,295,000

"Twenty years from now you will be more disappointed by the things you didn't do than by the ones you did do."



We offer Free Evaluations and Buyer Consultations!

Call Wayne Today!

RE/MAX Excellence

780-991-5107

